

Class of 2023
Incoming Freshmen Parent Night
Tuesday, January 22, 2019

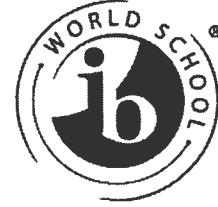

International Baccalaureate Presentation
5:45 – 6:15 PM
Little Theatre Rm #155
Kelly Murphy, IB Coordinator

Counselor Presentation
6:30 – 7:00 PM
Cafeteria

Informational Curricular Mini-Sessions
(Five 15-minute Mini-Sessions with 4 minutes between each Session)
7:00 – 8:30 PM
Classrooms

- | | | |
|-------|--|---------------------------------------|
| I. | Welcome – Introductions – Overview | Julie Villano, <i>Asst. Principal</i> |
| II. | Role of the Counselor | Nancy Barnes, <i>Counselor</i> |
| III. | Freshman 101 | |
| IV. | Daily Schedule | |
| V. | Graduation Requirements | |
| VI. | Course Selection Process | Craig Hawkins, <i>Counselor</i> |
| VII. | Cum Laude System – Honor Roll – GPA Calculation | |
| VIII. | NCAA Requirements | |
| IX. | Tutoring and other Support Systems | Misty Theisen, <i>Counselor</i> |
| X. | Freshmen Orientation | |
| XI. | Get involved – MHS Clubs and other opportunities | |

Secondary Course Offering Guide

Go to: www.mhs.midlandps.org > Counseling (tab) > Parent Resources (drop down window)

If you have any questions or concerns please contact one of the MHS Counselors:

Nancy Barnes	923-5203	BarnesNA@midlandps.org
Craig Hawkins	923-5211	HawkinsCE@midlandps.org
Misty Theisen	923-5205	TheisenMB@midlandps.org
Karen Dralle <i>Counseling Office Professional</i>	923-5091	DralleKM@midlandps.org

MEETING THE HIGH SCHOOL GRADUATION REQUIREMENTS

To graduate, a student needs 22 credits. Students generate credit by **PASSING COURSES**. Each semester course generates .5 semester hours of credit. Each year-long course generates 1 hour of credit per period.

Primarily credits toward graduation are earned in high school, however, high school equivalent math or world language courses taken by a middle school student are counted toward the graduation requirements and minimum 22 credits to graduate from high school. These courses will not be calculated into the high school GPA. GPA calculations begin in the fall when a student attends school as a full-time student in grade 9. Exceptions to this are high school honors courses and the third full year (five days a week) and above in a world language taken by a middle school student. These courses will earn credit towards graduation, honors points and GPA consistent with their high school counterparts.

Required credits include:

4 credits	Mathematics: Students must earn credit for Algebra I, Geometry, Advanced Algebra, and a math or math-related course during the senior year. Students may also select an Integrated Math four course (year) sequence.
4 credits	English Language Arts: Students must earn four credits.
3 credits	Science: Students must earn 1 credit of Biology or Survey of Biology, 1 credit of Physics, Survey of Physics or Chemistry, and 1 credit of an additional science course.
3 credits	Social Studies: Students must earn 1 credit of World History, 1 credit of US History, .5 credit of Government, and .5 credit of Economics.
2 credits	World Language: Students must earn 1 credit of world language AND 1 of these options: <ul style="list-style-type: none"> • Earn 1 credit in a second year of the same language OR • Earn credit(s) in a full CTE program (typically 2 credits over 2 years, see pages 56-62 for more information) OR • Earn one credit of Visual, Performing, Applied Art in addition to initial required credit of VPAA
1 credit	Health & Wellness and Physical Education: Students must earn .5 credit of Health & Wellness (no waiver available) AND one of these options <ul style="list-style-type: none"> • Earn .5 credit of Lifelong Fitness OR • Successful completion of a full year marching band or MPS high school sport – completed exemption form approved by counselor is required <p>Note: Lifelong fitness remains a prerequisite for all other physical education courses.</p>
1 credit	Visual, Performing, Applied Arts (VPAA) class: Students must earn one credit of Art, Music, or Applied Arts. <p>Note: If electing to use VPAA credit in lieu of the second year world language requirement, students must have two total VPAA credits. (See VPAA, next page)</p>
4 credits	General Electives
Non-credit requirement	An on-line course or learning experience of 20 clock hours, which can be incorporated into a course. All students will have a minimum of 10 hours in an online learning experience in English and 10 hours in social studies in their required classes. It is expected that students will have well over the 20 clock hours throughout their high school careers.

- All Midland Public School students are required to take all state and federal required assessments (SAT, M-STEP, & WorkKeys) and are expected to put forth their best effort.
- A Six-Hour Day for each of four years is required for graduation. All students attending a Midland Public School high school are required to take a six-hour academic day; this includes freshman, sophomores, juniors and seniors.
- Students must complete all graduation requirements in order to participate in commencement exercises, unless a special circumstance is approved by the Superintendent.

9th Grade Course Recommendation and Selection Sheet 2019-20

Instructions: **CAPITAL LETTERS** indicate **FULL-YEAR courses (1 credit)**. **Small letters** indicate **one-semester courses (.5 credit)**. The length of the class, if more than one hour, is indicated after the course. **DHS** after the course name indicates the course is taught only at Dow High School, **MHS** after the course name indicates the course is taught only at Midland High School. **(A)**-Accelerated, **(H)**-Honors courses, if letter appears at end of course.

* By recommendation only

If you travel to either high school to take a class offered only in that building, you will be scheduled for at least 3 hours in that building if you travel in the morning. If you travel in the afternoon, you will be scheduled for 2 or 3 hours in that building depending on your lunch hour.

Graduation Requirement 22 Semester Hours

- 4 English
- 4 Math: Algebra, Geometry, Algebra 2, 1 Math or Math-related class in Senior year
- 3 Science: Biology, Chemistry or Physics, 1 additional Science credit
- 3 Social Studies: World History, U. S. History, Government, Economics
- Health/Wellness (no exemption) and Lifelong Fitness or completion of full year marching band or MPS high school sport with completed exemption form on file with counselor.
- 1 Applied Music, Applied Arts
- 2 World Language or 1 World Language and 1 VPAA or completion of full CTE program.
- 4 General Electives
- 22 TOTAL**

Each 9th grade student has a 6-period day. The required subjects fill 4 periods. The remaining 2 periods must be filled. Three combinations are possible.

You may:

1. Elect 2 full-year courses, OR
2. Elect 1 full-year course & 2 semester courses, OR
3. Elect 4 semester courses.

A 7th period is optional. You can add another full-year course or 2 semester choices; however, if you choose seven hours you will be assigned seven hours and that cannot be changed in the future.

Required Subject Courses-Teacher Recommendation (Circle the teacher recommendation-these will be entered by the teacher/school)

ENGLISH: ENGLISH 9 A **EN3300**

MATH: INTEGRATED MATH 1 **MA3200** or ALGEBRA **MA3210** or ALGEBRA A **MA3300** or GEOMETRY A **MA4300** or GEOMETRY H **MA3400**

SCIENCE: BIOLOGY **SC3200** or BIOLOGY A **SC3300**

SOCIAL STUDIES: WORLD HISTORY **SS3200**

◆ If your student is considering a World Language, the teacher course recommendation is _____

Circle or highlight one Career Pathway of interest:

Arts & Communications	Business, Management, Marketing & Technology	Health Sciences	Human Service & Education	Engineering / Manufacturing & Industrial Technology	Natural Resources & Agriscience
-----------------------	--	-----------------	---------------------------	---	---------------------------------

ELECTIVES SHOULD BE CIRCLED OR HIGHLIGHTED (Choose at least 2 full year, 1 full year and 2 semester, or 4 semester courses)

Language Arts - Journalism, Drama

- EN3210 JOURNALISM
- EN3230 Drama 1
- EN3240 Drama Production
- EN3310* Debate & Discussion A
- EN3320* Public Speaking A

ART

- AR3200 BEGINNING ART
- AR4200* INTERMEDIATE ART

BUSINESS EDUCATION

- BU3200 MARKETING
- BU3210 Computer Technology 1
- BU3220 Computer Technology 2
- BU3230 Merchandising Operations
- BU3240 Sales Management
- BU3300 MARKETING A
- BU3310 Computer Technology 1 A
- BU3320 Computer Technology 2 A
- BU3330 Merchandising Operations A
- BU3340 Sales Management A
- BU4200 ACCOUNTING 1
- BU4330 ACCOUNTING 1 A

FAMILY & CONSUMER SCIENCE

- LM3200 Design for Career & Family
- LM3210 Food & Nutrition 1
- LM3220 Food & Nutrition 2

HEALTH

- HE3200 Health / Wellness

INDUSTRIAL EDUCATION

- IE3210 Introduction to Trades MHS
- IE3220 Hobby & Art Welding MHS
- IE3230 Car Care DHS
- IE3300 INTRO TO ENGINEERING DESIGN A
- IE3240 WOODWORKING 1 MHS

MATH ELECTIVE

- MA3220 COMPUTER SCIENCE ESSENTIALS
- MA4310 Computer Science 1 A
- MA4320 Computer Science 2 A

MUSIC

- MU3200 CONCERT BAND
- MU3210 CHORUS
- MU3220 CONCERT ORCHESTRA
- MU4300* SYMPHONIC BAND A
- MU4310* CONCERT CHOIR
- MU4320* SYMPHONIC ORCHESTRA A

PHYSICAL EDUCATION

- PE3200 Lifelong Fitness -- 1st PE Taken
- PE4212 Cond & Weight Trng -- 2nd Sem
- PE4222 Team Sports -- 2nd Sem

WORLD LANGUAGES ◆

- WL1230 SURVEY OF SPANISH 1
- WL1300 SPANISH 1 A
- WL1210 GERMAN 1 DHS .2 (.3=WL1310)
- WL1220 FRENCH 1 MHS .2 (.3=WL1320)
- WL2230 SURVEY OF SPANISH 2
- WL2300 SPANISH 2 A
- WL2210 GERMAN 2 DHS .2 (.3=WL2310)
- WL2220 FRENCH 2 MHS .2 (.3=WL2320)
- WL3300 SPANISH 3 A
- WL3310 GERMAN 3 A DHS
- WL3320 FRENCH 3 A MHS

MISCELLANEOUS ELECTIVE OPTIONS

- EN3220* YEARBOOK
- ME3200* STUDENT LEADERSHIP

SPECIAL EDUCATION

- EN3110 WRITING ACCELERATION
- EN3120 READING ACCELERATION
- EN3100 ENGLISH 9
- MA3100 PRE-ALGEBRA
- MA3160 INTEGRATED MATH 1
- SC3100 BIOLOGY
- SS3100 WORLD HISTORY
- BU3110 Keyboarding / Computer Applications
- HE3100 Health / Wellness
- IE3100 PRE-VOCATIONAL TRAINING
- LM3130 PERSONAL ADJUSTMENT
- LM3100 Learning Strategies
- LM3110 LEARNING STRATEGIES Math
- PE3000 HEALTH MAINTENANCE DHS

OTHER COURSES NOT LISTED

Course # Course Name

Excused Hour

EN3270 - 7th hour excused

PLEASE LIST AN ALTERNATE ELECTIVE (An alternate must be listed. If you do not list an alternate elective, one will be assigned for you.)

Do you want a seventh hour class?

YES NO

If you want a seventh hour class, **NO** transportation will be provided.

Which high school will you attend?

H.S. Dow High Midland High

You must apply for Schools of Choice if you are not going to attend your neighborhood school. Does the above choice require a Schools of Choice application?

YES NO

I understand classes are offered based on these selections. Changes in these selections may not be possible.

Print Student Name

Student Signature

Student Phone Number (summer)

Parent Signature

Grade Point Averages (GPA)

The high school GPA is calculated for high school courses that earn credit towards graduation. Except in specific situations, a student's GPA is calculated beginning the first day of a student's ninth grade year. The exceptions in which GPA is also calculated are middle school students who take high school level honors courses and/or the third year of high school equivalent world language.

The following circumstances earn credit towards meeting the graduation requirements, but do not earn honor points and are excluded from the GPA calculation:

- High school equivalent math or world language courses taken by a middle school student other than the exceptions above.
- Credit for a course earned by a student through the test out process. (See Test Out Guidelines)
- Courses "passed" under the pass/fail option. (See Guidelines for the Pass/Fail Option)
- Independent Study courses. (See Guidelines for the Independent Study)
- Employment Credit. (See Employment Credit)
- Career Training. (See Career Training)
- College Courses transfer in as high school credit. (See College Courses Option)

Online learning and dual enrollment courses will be included in the GPA calculation. Most courses will be calculated at the .2 standard using the 4.0 scale. However, individual courses may be evaluated by the district for the .3 accelerated or .4 honors level based on a comparative relationship with traditional district courses. Online courses can be taken pass/fail in accordance with the pass/fail guidelines. Dual enrollment courses are not eligible for the pass/fail option.

A weighted GPA (career GPA on transcript) is calculated according to the below table with appropriate point level factors. An unweighted GPA is calculated with all courses being at the standard level (.2).

CALCULATING THE GPA

GRADE/HONOR POINT EQUIVALENCE TABLE

GRADE EARN	.2 COURSES			.3 ACCELERATED COURSES			.4 HONORS COURSES		
	GRADE EQUIV.	CREDIT	HONOR POINTS	GRADE EQUIV.	CREDIT	HONOR POINTS	GRADE EQUIV.	CREDIT	HONOR POINTS
A	4.0	x 0.5	2.0	4.6	x 0.5	2.3	5.0	x 0.5	2.5
A-	3.6	x 0.5	1.8	4.2	x 0.5	2.1	4.6	x 0.5	2.3
B+	3.4	x 0.5	1.7	4.0	x 0.5	2.0	4.4	x 0.5	2.2
B	3.0	x 0.5	1.5	3.6	x 0.5	1.8	4.0	x 0.5	2.0
B-	2.6	x 0.5	1.3	3.2	x 0.5	1.6	3.6	x 0.5	1.8
C+	2.4	x 0.5	1.2	3.0	x 0.5	1.5	3.4	x 0.5	1.7
C	2.0	x 0.5	1.0	2.6	x 0.5	1.3	3.0	x 0.5	1.5
C-	1.6	x 0.5	0.8	2.2	x 0.5	1.1	2.6	x 0.5	1.3
D+	1.4	x 0.5	0.7	2.0	x 0.5	1.0	2.4	x 0.5	1.2
D	1.0	x 0.5	0.5	1.6	x 0.5	0.8	2.0	x 0.5	1.0
D-	0.6	x 0.5	0.3	1.2	x 0.5	0.6	1.6	x 0.5	0.8
E	0			0			0		

1. Calculate Honors Points for each course.

Honors points for each course are calculated by using the row of the GRADE EARNED in the course. Using the columns for the course level (.2, .3 or .4), the GRADE EQUIVALENT is multiplied by the CREDIT.

Report Card Example:

Course	Course #	Credit	Grade	Honor Points = GRADE EQUIV x CREDIT
<u>Lit Exploration & Composition</u>	EN4202 - 3	0.5	B	= 3.0 x 0.5 = 1.5
<u>Geometry A (.3 Accelerated)</u>	MA4312 - 4	0.5	B	= 3.6 x 0.5 = 1.8
<u>Concert Band</u>	MU3202 - 1	0.5	A	= 4.0 x 0.5 = 2.0
<u>IB AP Adv Bio HL H (.4 Honors 2 hrs)</u>	SC5402-2	1.0	C+	= 3.4 x 1.0 = 3.4
<u>US History</u>	SS4222 - 9	0.5	B+	= 3.4 x 0.5 = 1.7

CUM LAUDE RECOGNITION

The Cum Laude system distinguishes student academic performance at three levels:

- Summa Cum Laude: 4.5 GPA and above
- Magna Cum Laude: 4.20 – 4.49 GPA
- Cum Laude: 3.80 – 4.19 GPA

GPA's are calculated by averaging the student's first seven semester grades earned in the Midland Public Schools. Students whose GPA's are 3.80 or above will have the appropriate Cum Laude designation on their transcripts. Class rank will be available only in a response to a formal, written request by the college/university/organization to the principal or designee of our high schools.

ACADEMIC HONOR ROLL POLICY

Midland Secondary Schools

To be on the All A Honor Roll, students must have a **4.0 (A) grade-point average** for the semester. To be on the Academic Honor Roll, students must have a **3.0 (B) grade-point average** or higher for the semester. Honor Rolls will be computed each semester independent of one another.

At least the final six weeks of school work involved must have been in a Midland district school for a student to be eligible for the Honor Roll.

Only **non-weighted** "final" grades will be used. All final grades will be of equal weight. Any final grade below a **C- (D or E)** disqualifies a student from the honor roll for the semester.

In determining 6th grade honor rolls, the only 6th grade subjects to be used are language arts, math, science and social studies. Encore classes will not be figured into the computation.

When grades earned in other districts are of a different type than **A** through **E**, building administrators will interpret the transcripts and, in cases of doubt, the Midland grades will be the determiners.



ATHLETICS

Eric Albright, Athletic Director
Sara Kuch, Office Professional

AlbrightET@midlandps.org
KuchSA@midlandps.org

Athletes and their parents must register and complete the Athlete Online Registration at www.chemics.net for each sport/season prior to participation.

Sports offered at Midland High School include the following:

Fall Sports: Cross Country, Football, Girls Golf, Volleyball, Boys Soccer, Cheerleading, Pompon, Girls Swimming, and Boys Tennis

Winter Sports: Boys Basketball, Girls Basketball, Boys Bowling, Girls Bowling, Wrestling, Hockey, Boys Swimming, Competitive Cheerleading and Pompon

Spring Sports: Baseball, Softball, Boys Track, Girls Track, Girls Soccer, Boys Golf, Girls Tennis, Boys Lacrosse, Girls Lacrosse (co-op with HH Dow)

Midland High School athletic rules are in accordance with the philosophy and code of Midland Public Schools. Midland High School will award varsity letters in all sports on completion of the required standards.

All athletes are required to pay an activity fee either online at www.midlandps.org or direct payment in the athletic office (except bowling fees which are paid directly to the coach at the start of the season). Fees are \$150 for each sport except fall cheer and fall and winter pom which are \$75. Winter cheer is \$150 because it is competitive cheer. There is a \$300 cap per athlete, per year. Activity fees are waived for students who receive free or reduced lunch. Scholarships are also available. Complete details can be found on the Midland Public Schools website.

All interscholastic athletic contests are regulated by the Michigan High School Athletic Association. These rules of procedure are minimum regulations. Each individual high school can require more stringent regulations if it so desires. Listed below are some of the factors that affect eligibility:

1. You must be a student of Midland High School.
2. You must have passed at least 4 out of 6 or 5 out of 7 classes the previous semester.
3. Your cumulative grade for the semester to date must be passing in at least 66% of your classes. Grades are checked every 9 weeks.
4. There is an age limit on athletic competition. If you are 19 before September 1st you are not eligible to play sports.
5. You cannot accept pay or any gifts of merchandise of any value for participating in any athletic competition from the time you enter high school until you graduate, including the summers following the ninth, tenth and eleventh grade years, and continue to participate in high school sports. Medals, plaques or trophies are not to exceed \$25.00 in value and can be presented to you only by your school.

6. You are eligible for four first and four second semesters of competition which includes all semesters officially registered in school, whether you participate in a sport or not.
7. Rules governing eligibility are too numerous to list here. Your coach and athletic director have a copy of these rules. If there are doubts, see either one of them to avoid endangering your eligibility.
8. Each school year every student who is to compete in any sport must pass a medical examination given by a physician who fills out a form provided by the school. Each athlete must have a completed physical/training rules card on file in the athletic office **before** being allowed to tryout or practice with any team. Physical exams must be administered **after** April 15th of the previous school year to be considered valid for the following school year (ex: a physical done after 4/15/18 would be valid for the 2018-19 school year). Every student who is out for a sport must have insurance or a signed waiver on file.

In case of an injury, students are readmitted to activity only by reexamination. In case of operations or extended illness, the student must present a physician's statement that the amount of participation in sports or physical education which the student is undertaking is believed to be safe.

Athletic Events

Whether at home or at other schools, we have an obligation to show appreciation for good play on the part of either team. Doing this promotes good relations with our opponents. Booing, name calling or taunting officials and players is not good sportsmanship. Be positive and courteous to players and fans alike. All school rules outlined in the Code of Student Conduct are to be followed at all contests, home or away. Good sports are winners.

Fall Cheerleading and Pom

Cheerleading and Pompon Squads are expected to follow the guidelines of the athletic program at Midland Public Schools. Members of these squads are subject to the athletic eligibility requirements and receive awards based on the same criteria as other athletes. The primary function of these squads is to promote school pride and good sportsmanship through positive cheers and appropriate performance. Although these squads do not compete interscholastically on a regular basis, there are opportunities for competition. Fall and winter squads for both Cheerleading and Pompon are selected through tryouts prior to each season. Squad coaches determine practice times and required attendance at games.

MUSIC

<i>Dan Farison, Chorus</i>	FarisonDS@midlandps.org
<i>Anna Mamassian, Orchestra</i>	MamassianAE@midlandps.org
<i>Bill Monroe, Band</i>	MonroeWH@midlandps.org
<i>Chris O'Connell, Band</i>	OConnellCJ@midlandps.org

Midland High School has outstanding musical groups -- band, orchestra, and choir. Activities include Rhapsody Rendezvous, community engagements, concerts and other performances. Previous experience in band and orchestra at the middle school is desired for participation in the MHS band or orchestra. Instrumental and vocal students participate in

district and state festivals, solo and ensemble festivals and Michigan Youth Arts.

Symphony Orchestra, Symphonic Band and Meistersingers are designated advanced ensembles made up of students who audition to become members of the ensemble. An invitation to join the band, chorus and concert orchestra is extended to all students.

CLUBS

Midland High School offers a variety of clubs that meet the interests and needs of students. Clubs provide opportunities for self-expression, leadership training, knowledge, service and camaraderie with people of similar interests. To be officially sanctioned a club must have Student Council approval and faculty sponsorship.

Anime Club (*Ms. Francisco*)
FranciscoAM@midlandps.org

Anime Club is a place where students can enjoy various Japanese animated or inspired shows, discuss and participate in videogame-centered events, play card games, hone their creative drawing and storytelling skills and discuss comics in an after-school setting. Each meeting has a different focus but all are welcome to come and nerd out.

ATLAS (*Mr. Starling*)
StarlingMF@midlandps.org

ATLAS is a political discussion group for students who are interested in politics and political behavior. The club meets periodically to discuss the relevant issues of the day.

Beautification Club (*Mrs. Witt and student volunteers*)
Students interested in helping MHS become a showcase high school by creating gardens inside or outside on campus are welcome to join and share ideas to help beautify MHS! Any interest in flowers, gardening, planting, building, or designing landscapes, this club is for you!

Building Trades Club (*Mr. Dodick*)
DodickKR@midlandps.org

The Building Trades Club is a co-curricular organization for students enrolled in the building trades program. The club provides students with an opportunity to compete in a variety of skills competitions such as the Delta Skills Day, Skills USA and MITES. Leadership development and community service are also important components of the club.

BPA - Business Professionals of America
(*Ms. Jozwiak; Ms. Mahabir*)
JozwiakAM@midlandps.org
MahabirER@midlandps.org

BPA is for any student interested in business, finance, marketing or technology. BPA prepares students for the business workforce through leadership, citizenship, academic and technological skills. The chapter participates in fundraising and community service activities. Midland High School's chapter of Business Professionals of America continually wins top awards at regional, state, and national competitions.

Central Michigan Brain Bee Competition (*Mr. Welter*)
WelterPT@midlandps.org

The Brain Bee is a competition held every year for students who are interested in learning about the brain. Students compete at the local chapter of the Brain Bee Competition at CMU. Medals are awarded to the top three winners and the first place winner is given a chance to compete at the National Brain Bee Competition.

Chess Club (*Mr. Criner*)
CrinerJA@midlandps.org

The Chess club is for students interested in learning to play chess and those students interested in improving their chess playing skills. Students meet once a week and play in tournaments.

Computer Programming Club (*Mr. Fox*)
FoxRW@midlandps.org

Computer Programming Club is geared toward students who have a high interest in computer programming, want to advance their programming and problem solving skills and wish to exercise those skills competitively. This club gives students the opportunity to work with a team to solve unique and challenging problems using a computer. It is recommended that students take at least one programming course at MHS or possess prior programming experience before joining.

Creative Arts Club (*Ms. Francisco*)
FranciscoAM@midlandps.org

The Creative Literature Arts Club is an after-school opportunity for students to write with other students and get additional input/support for their personal writing projects. We offer resources and a workshop-like environment for students who would like to hone their creative writing skills whether they are interested in poetry, novels, script-writing or other creative writing venues.

Drama (*Ms. Applegate*)
ApplegateME@midlandps.org

Midland High School has earned a reputation for its award-winning theatre productions, which are open to all interested MHS students. Such productions include a fall play, a one-act competition play and a spring musical. Prior to each production, scripts are made available and open auditions are held. In addition to performance opportunities, these productions provide students with a variety of behind-the-scenes technical activities: makeup, costuming, program design, set design and construction, sound, and lighting.

DECA – An Association of Marketing Students
(*Ms. E. Marsh*)
MarshEA@midlandps.org

DECA is for the executives of tomorrow. It is a marketing oriented club for high school students who are interested in a variety of marketing fields, including sports & entertainment marketing. This group competes at the regional, state, and national levels, creating the opportunity to travel, meet other students with similar interests and have fun. Not to mention the scholarship opportunities. All students enrolled in any business class are welcome.

Electronics and Wireless Communications (Mr. Fawcett)

FawcettAM@midlandps.org

This Club is open to any high school student in Midland County. Want to expand your space? Want to see and do things beyond the world you're accustomed to? The Electronics and Wireless Communications club is a place to have fun with a variety of technologies such as electronics, programming computers to sense and control things, wireless communications, and remote sensing. Would you like to be part of a team to launch a science payload into near space and recover it? If you said yes to any of these questions, this club is for you! The club's activities are supported by volunteers from the Midland Amateur Radio Club.

Equestrian Club (Ms. Johnston)

The Midland High Equestrian Team competes at the High School level competitions in the early fall. Practices begin in spring and continue weekly through the summer. The competitions begin after Labor Day and end with State Finals in October. Riders need to be able to ride all gaits and attend all show competitions. Beginning riders are welcome as grooms. This is a fun, competitive sport involving all disciplines of riding.

Family, Career and Community Leaders of America

(Ms. Boychuck)

BoychuckCA@midlandps.org

FCCLA is an organization for students enrolled in family and consumer science classes. FCCLA promotes personal growth, citizenship and leadership development for students and encourages participation in regional and state competitions as well as community service projects.

Frisbee Golf (Mr. Pellegrino)

PellegrinoNE@midlandps.org

The Frisbee Golf Club is open to all MHS students. We will be meeting at the local course by the Tridge on Tuesdays and Thursdays after school from mid-September until the end of October. It will be a relaxed atmosphere where everyone works on improving their skills and having fun!

Forensics (Ms. Applegate)

ApplegateME@midlandps.org

Midland High School has an active program for students interested in interscholastic speech activities, regardless of prior experience. While taking classes to prepare for competition in Forensics is recommended, it is not required. Interscholastic Forensics competitions take place during the second semester. Students can choose from fourteen public address/oral interpretation events including Broadcasting, Storytelling, Oratory and Impromptu.

Gay Straight Alliance (Mrs. Aviles; Mr. Mikusko)

AvilesHR@midlandps.org

MikuskoJT@midlandps.org

The GSA club is a student-run club that emphasizes making Midland High School a safe space. The club brings together LGBT and straight students to support each other, provide a safe place to socialize, and create a platform for activism to fight bullying, homophobia, and transphobia.

Green Club (Mr. Edelbrock)

EdelbrockBM@midlandps.org

The Green Club hopes to increase Midland High students' awareness of (and possible solutions to) environmental issues. Their most prominent work will be to make it more common, and easier, for Midland High students and staff to recycle.

International Students Club (Ms. Wixtrom)

WixtromSJ@midlandps.org

The International Students Club organizes, promotes and supports cultural, social and sportive activities representing its members who are from diverse cultures. All students are welcome to join. This club presents an opportunity to meet and become friends with new people from all around the world.

Key Club (Ms. Dodick; Mr. Yoder)

DodickSM@midlandps.org

YoderJG@midlandps.org

Key Club is an internationally recognized service club that actively provides ways for students to participate in improving our school and community. We are involved in a wide range of activities including organizing MHS blood drives, bell-ringing for the Salvation Army, taking part in the Midland area CROP Walk, helping with elementary school carnivals, and dozens of other group and individual volunteer opportunities. The club is open to any and all MHS students who want to make a contribution to help improve our school, community, and world!

MHS Quiz Central Team (Mr. Criner)

CrinerJA@midlandps.org

The Quiz Central competition consists of high school students from 32 schools in the WCMU, Central Michigan University TV viewing area who compete in an educational and academic quiz show. The competition is filmed and put on television.

Model United Nations (Mr. Mulvaney)

MulvaneyJB@midlandps.org

Model UN is a group that studies global public policy issues. Members of this group attend conferences representing a country and debating the issues from that country's point of view.

National Art Honor Society (Ms. Bishop; Mr. Scherzer)

BishopKM@midlandps.org

ScherzerJB@midlandps.org

National Art Honors Society is open to any student that is interested in Art. The club meets twice a month on the 2nd and 4th Tuesdays in Room #320. The group allows students to work on MHS projects, community service, art scholarship opportunities and individual art projects.

National Honor Society (Mr. Smith; Mr. Gates)

SmithD@midlandps.org

GatesAM@midlandps.org

The National Honor Society is sponsored by the National Association of Secondary School Principals. Its purpose is to recognize and encourage academic achievement while developing other characteristics essential to citizens in a democracy. Membership in the National Honor Society is based upon excellence in four areas: scholarship, leadership, character and service. The National Council of the National Honor Society establishes the procedures by which the

Faculty Selection Committee chooses the candidates for induction.

Students who have a cumulative grade point average (GPA) of 3.4 or higher at the end of their first semester as a junior are eligible for selection with a May induction. Seniors with a cumulative GPA of 3.4 or higher as a first-semester senior are eligible for selection with a January induction.

The goals of the Chemic Chapter are to: create an enthusiasm for scholarship; stimulate a desire to render service; promote leadership in our community; develop character in our schools; and bring the achievements of outstanding high school students to the attention of their classmates, community, and colleges they plan to attend.

Peer Tutoring (Mr. Smith; Mr. Gates)

SmithD@midlandps.org

GatesAM@midlandps.org

Students who would like extra help with any of their academic classes are invited to visit The Learning Center. The National Honor Society provides tutoring on either a short or long-term basis to MHS students. If you're having difficulties with your math homework, editing a paper or if you would like a long-term chemistry or Spanish tutor, please see either of us in person. A tutor will be assigned to you shortly after we meet with you.

Photography Club (Ms. Rogers)

RogersKK@midlandps.org

Photography club meets about twice a month throughout the school year. Sometimes we go on photography field trips, other times we have speakers visit and critique work. We spend time learning photo editing skills. We also held a photo booth at both the Homecoming and Snowcoming dances last school year.

Publications (Mr. Woehrle; Ms. Thomas-King)

WoehrleJA@midlandps.org

KingBJ@midlandps.org

The student newspaper, *Focus*, is an award-winning publication that gives students an opportunity to get involved in a hands-on activity that includes reporting, writing and editing, photography, and desktop publishing. Open to all students who are in a journalism class, the staff produces nine regular issues a year, including a special Senior Class commemorative issue of Focus. Mr. Woehrle is the club advisor. The *Chemic Yearbook* provides students with many of these same opportunities. Students must be enrolled in the yearbook class to participate. Ms. Thomas-King is the yearbook advisor.

Rhapsody Rendezvous (Music Parents)

Rhapsody Rendezvous is a Midland High School talent show sponsored by the Music Parents. Try-outs will be held the beginning of October. Dates are announced and posted in Eyeball Alley. Sign-up sheets are posted on the student bulletin board outside the Attendance Office. Tickets are sold during the week of Rhapsody at MCFTA.

Robotics Club (Mr. Younkin)

YounkinBR@midlandps.org

The MHS Robotics Team is associated with FIRST (For Inspiration and Recognition of Science and Technology). This volunteer-based organization creates a new robotics

competition every year for FIRST teams across the nation to compete in regional events. It focuses on getting young people to enjoy and appreciate science and technology.

S.A.V.E. (Ms. Dodick; Ms. Bank)

DodickSM@midlandps.org

BankAC@midlandps.org

Students Against Violence Everywhere is a group that brings violence issues of all types to the forefront of our student body. This is done through prevention activities, interaction with middle school and elementary school children, working closely with the Midland Violence Prevention Partnership and student-led presentations. Topics focus on bullying, dating violence, domestic violence, violence in media/entertainment and much more.

Science Olympiad (Mr. Reinhardt)

ReinhardtBP@midlandps.org

Science Olympiad is a school sponsored team which involves teams of 2 students competing in 20 or more events related to science and technology. These include building projects, biology related tests and experiments, and events that test skills in all areas of science. The teams begin meeting in October and then once every couple weeks until competition time nears then typically once per week. Students may compete at Delta to practice in preparation for future years of competition. No experience is needed. Students with past experience and new members are encouraged to join.

Student Council (Ms. Albright)

AlbrightMR@midlandps.org

The Student Council is the student government of Midland High School. It provides and supervises activities for students. Membership consists of representatives from each grade and an executive board consisting of a president, vice-president, secretary and treasurer that are elected by the student body each spring. Freshmen, sophomore, junior and senior class representatives and officers are elected in May of the previous school year. Students that would like to be president or vice president of their class, or a member of the executive board, must be a member of the Student Leadership class. In order to be placed on the ballot to run for a position, one must submit an application to the Student Council and participate in an interview. The student must be a full time Midland High School student in good standing in his/her class.

Trap Shooting Club (Ms. Kennemer)

KennemerLJ@midlandps.org

The MHS Trap Shooting Club is open to all MHS students. Meetings are held at the Freeland Conservation Club on Wednesday evenings in March and April to practice and compete against other teams in the State of Michigan. In June the team travels to Mason, Michigan for the Annual Michigan High School Trap Shooting Association competition. There is no previous experience necessary.

Welding Club (Mr. Pawlak)

PawlakCM@midlandps.org

The Welding Club is a co-curricular organization for students enrolled in the welding technology program. The club provides an opportunity to compete in a variety of skill competitions such as Skills USA, Delta Skills Day, and Ferris State University Welding Competition. The activities of the welding club also serve to promote leadership development and community service.

MIDLAND HIGH SCHOOL

Informational Curricular Mini-Sessions

January 22, 2019

SUBJECT	ROOM	SESSION	FACULTY
Art	320	1,2	Ms. Bishop
Athletics	Cafeteria	1	Mr. Albright
Physical Education	Cafeteria	2	Ms. Sugnet
Career & Technical Ed Co-Op	137	All	Ms. Jozwiak
Engineering Pathway/Program	122	1,2,3	Mr. Last
English	356	All	Ms. Bank Ms. Dodick
Health & Wellness	Cafeteria	2	Ms. Downing
Mathematics	242	All	Mr. Fox Mr. Smith
Music	209	1,2	Mr. Farison - Choir Ms. Mamassian - Orchestra Mr. Monroe - Band
Science	219	All	Mr. Edelbrock
Social Studies	328	All	Ms. Beson-Steger Mr. Mulvaney Mr. Wontorcik
Special Education	233	All	Ms. Laures
World Language French Spanish	358	All	Ms. Rankin

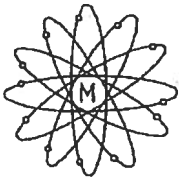

Chemics

Midland High School

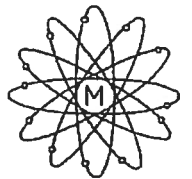

Chemics

Third Floor

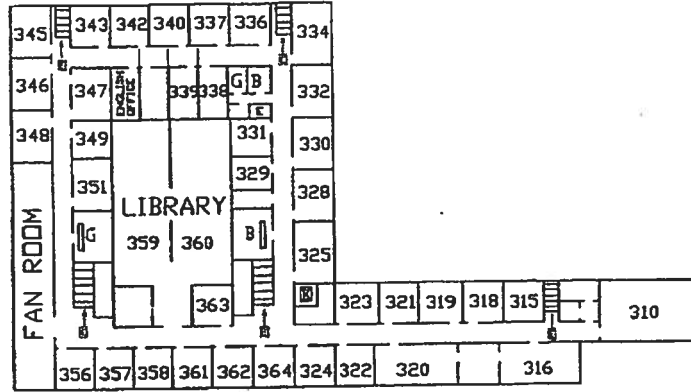

Second Floor
(Ground Floor)

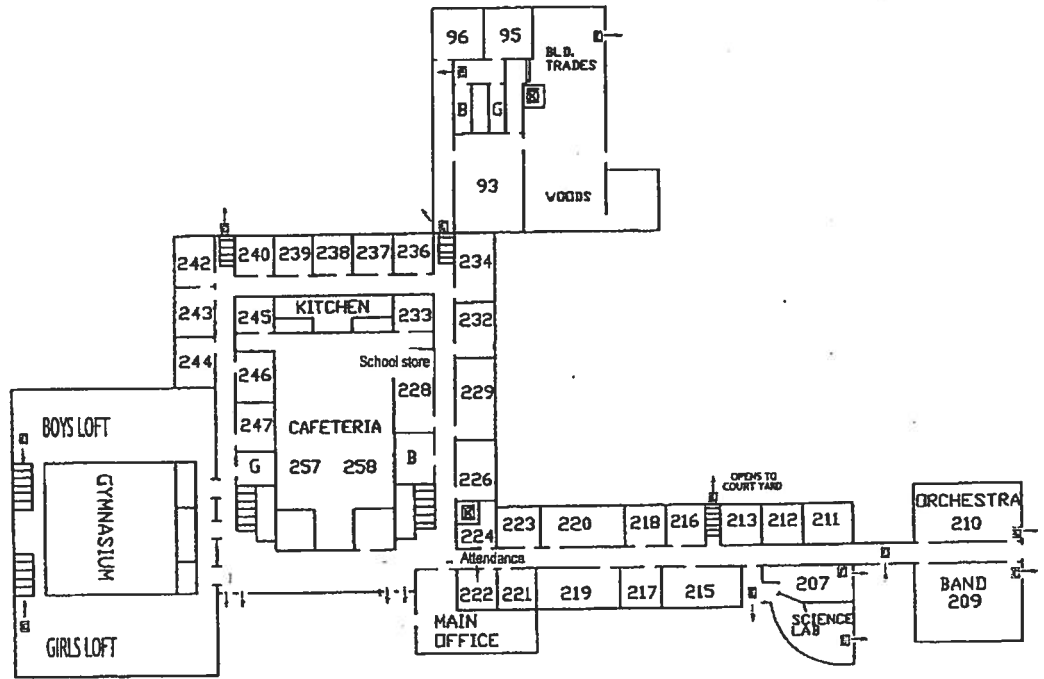

First Floor

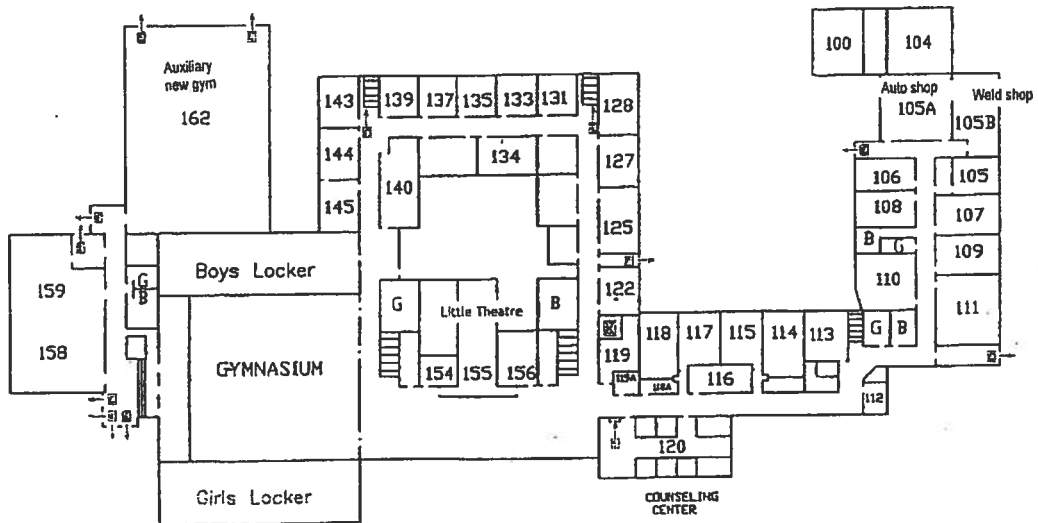

Midland High School



Classroom Hours/Schedule

<u>1st Hour</u>		
7:40 8:35		
<u>2nd Hour</u>		
8:41 9:36		
<u>3rd Hour</u>		
9:42 10:47		
<u>4th Hour</u>		
1st Lunch	10:53	<i>Class Time</i>
	11:23	
<i>Class Time</i>	11:28	2nd Lunch
	11:48	
	11:53	
	12:23	
<u>5th Hour</u>		
12:29 1:24		
<u>6th Hour</u>		
1:30 2:25		
<u>7th Hour</u>		
2:30 3:25		